

*If you've been dreaming of
your own log home. . .*

*then it's time to talk to
Contemporary Log Homes. . .*



Contemporary
LOG
HOMES, llc
We Deliver Dreams!

It's Time to Talk to Contemporary Log Homes

THE LAKEVIEW - 2,972 sq. ft.



The Lakeview model was designed for grand views and livable spaces. The comfortable front porch allows a casual entry into a foyer that opens up into a truly striking great room with unlimited views thru floor to ceiling windows. The eyes focus to a view beyond, perhaps a lake, hence the name.

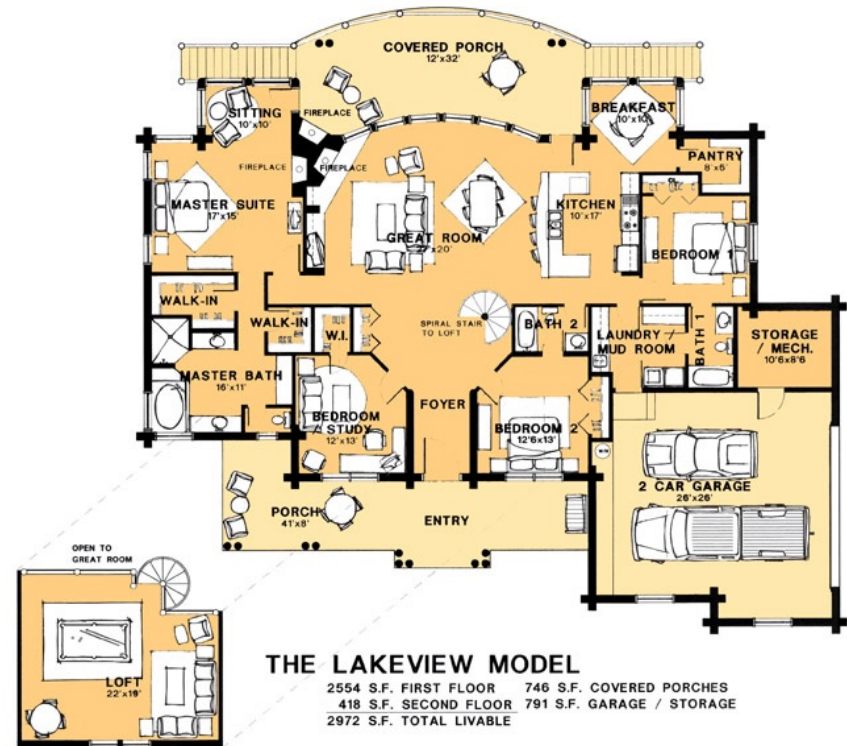

The barrel-vaulted wood ceiling extends from the loft through the great room and over the covered porch in the rear of the house, lending a grand view and stunning impact on the common living spaces.



The kitchen and breakfast areas are an integral part of this space and occupants become a part of the interaction taking place; not abandoned in a separate room. The elegant master suite allows for the privacy and luxury of a five star resort.

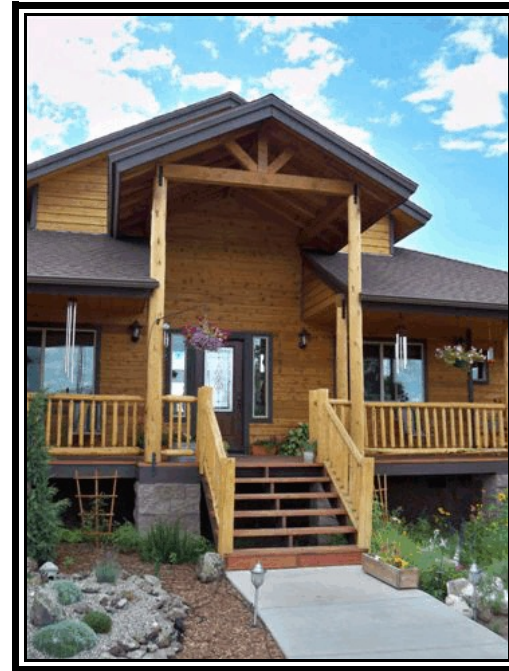

The Lakeview - 2,972 sq. ft.
Material Package Price: \$129,625.00

STANDARD MATERIAL PACKAGE INCLUDES:

SILL PLATE:	2x8 pressure treated or redwood plate.
FLOOR SYSTEM:	2x floor joists with 3/4" T&G OSB or plywood sheathing & girder beams.
PORCH FLOORS:	2x floor joists with 2x6 decking.
LOG WALLS:	7" dia. Swedish cope, lodge pole pine and douglas fir mix.
INTERIOR PARTITIONS:	2x4 or 2x6 studs @ 24" o.c.
STAIRS:	2x12 stringers and treads.
LOG GUARDRAILS:	2" dia. pickets @ 5" o.c. with 4" dia. rail on stairways & 2nd floor balconies
ROOF SYSTEM:	2x roof rafters with 1/2" OSB roof sheathing (or 5/8" OSB where required by code).
PORCH ROOF SYSTEM:	2x roof rafters with 1/2" OSB roof sheathing (or 5/8" OSB where required by code).
FASCIA:	2x S1S2E spruce or pine with 1x4 shingle molding.
ROOFING:	30 yr. Architectural fiberglass shingles over 15 lb. roofing felt.
BASIC BUILDING HARDWARE:	Joist hangers, hurricane ties, roof straps, log wall bolts & construction adhesive between each course of logs.
CONSTRUCTION MANUAL:	A simple step by step "how-to" guide.
BLUEPRINTS:	Five complete sets of permit ready plans prepared by registered architects.

LOG FINISH MATERIALS:

"Sashco" products: Log Jam chinking for interior & exterior joints/seams. Capture exterior stain and Cascade exterior clear coat. Symphony (2 coats) interior clear coat finish.

TECHNICAL ASSISTANCE:

A Contemporary Log Home representative will assist the construction crew at the construction site in starting log walls from the first floor.

FREIGHT:

Included to the construction site if the materials are paid for prior to shipping in the AZ, CO, UT areas. Additional freight costs will apply for all other areas.

MANY POPULAR OPTIONS ARE AVAILABLE:

6x8 D-shaped logs
8", 9", 10" & 12" diameter logs
Metal Roofing
Window Packages
Heavy Timber Structures

Pre-fitted Natural Hand Hewn Logs
Hand Peeled Machine Logs
Log Stairs
Door Packages
Custom Design by Registered Architects

Thanks for taking the time to consider us as part of your dream. Call one of our representatives today or anytime. We don't have a clock when it comes to customer service!



Western Region
4542 East McKellips Road
Suite 101
Mesa, AZ 85215
(480) 894-1715

Eastern Region
25950 Hayden Lane
Edinboro, PA 16412
(814) 734-8716

Visit us on the web at www.chllc.com
Email: deliverdreams@chllc.com